

Westward Ho! HOLIDAY CENTRE

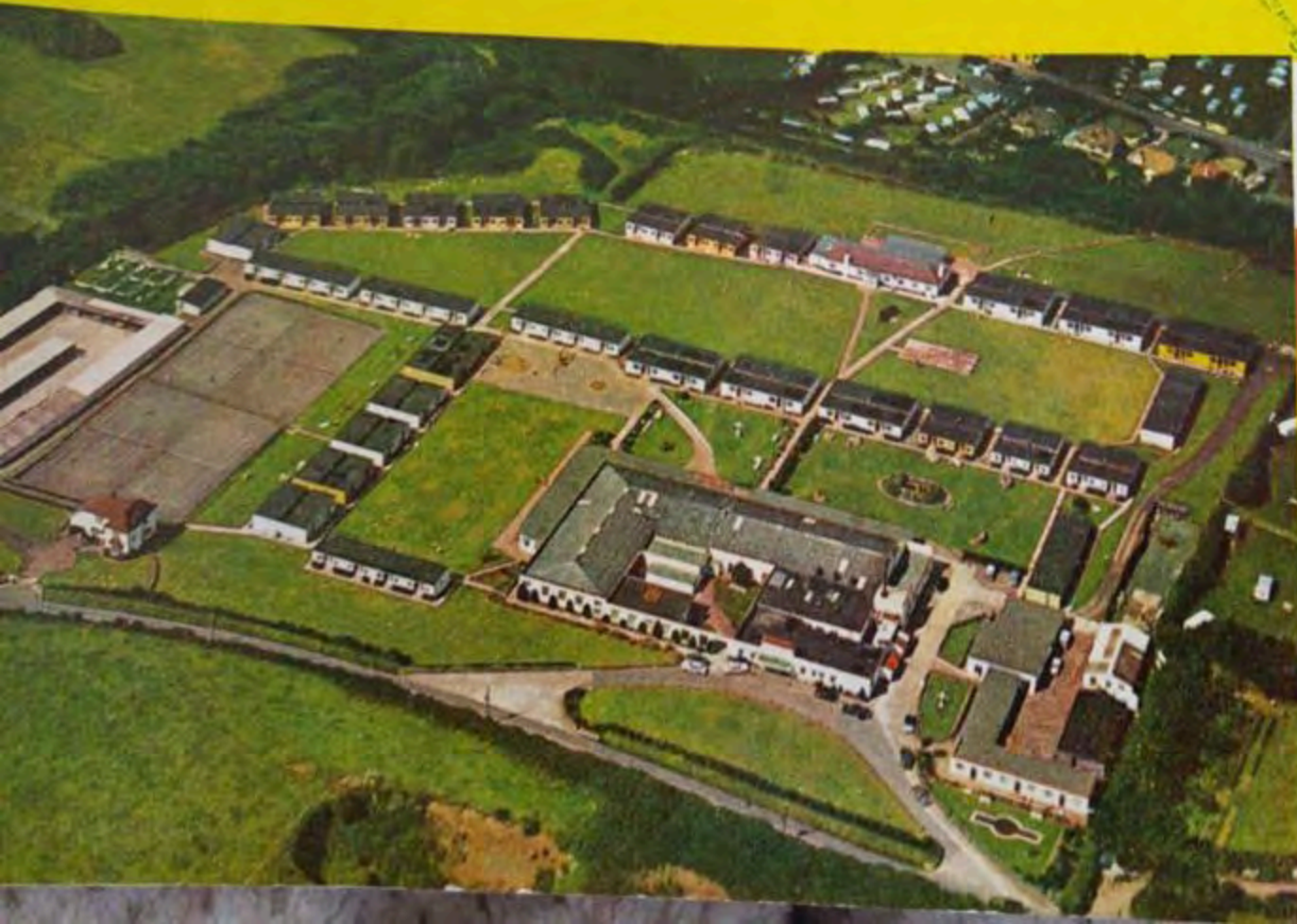

Where all find

Holiday fun



There is a friendly holiday welcome for *everybody* at Westward Ho! and you feel it as soon as you enter the Centre.

Here young and old can have a really grand time—there's so much for each of them to enjoy.



Plan of double chalet

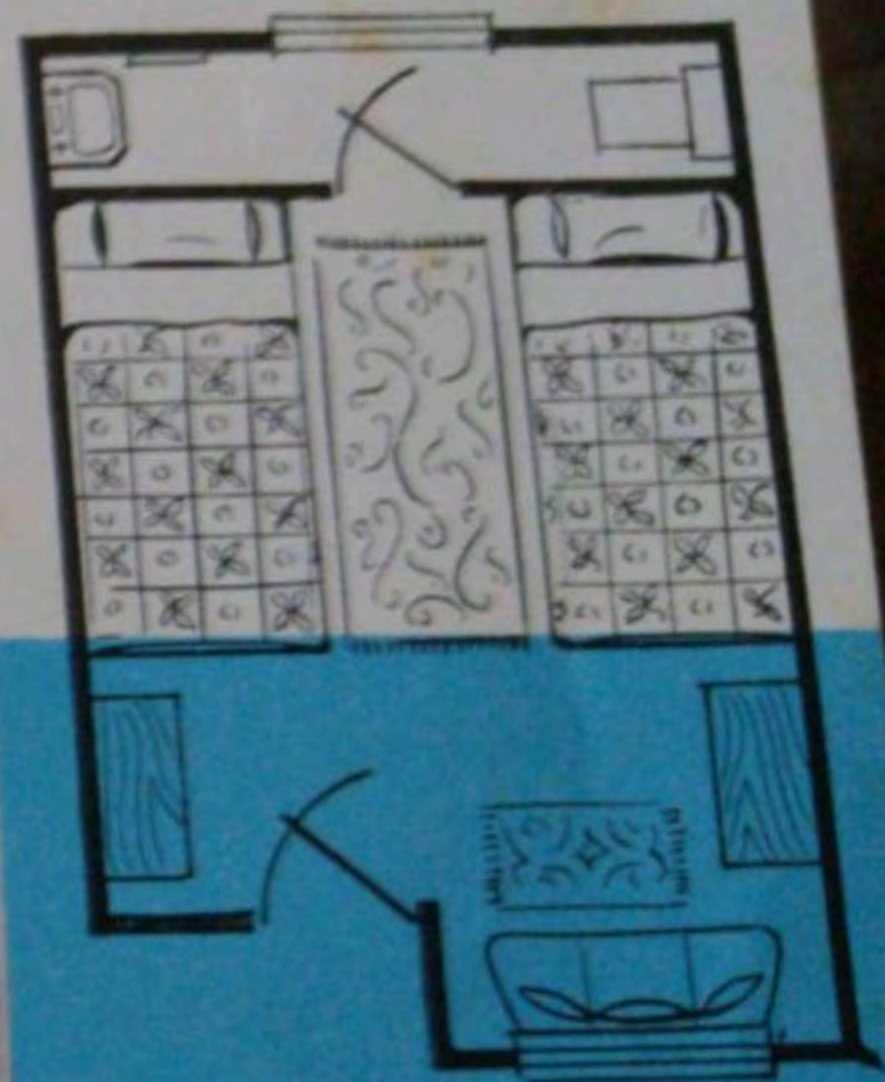

All double and family chalets are fitted with wash-hand basin, running hot and cold water, and their own toilet. Inside each block of single chalets are toilets, wash-hand basins, and a bath. All chalets are adequately furnished and every bed is fitted with an interior-spring mattress. Baths and showers are available.



There is accommodation for a limited number of guests in Windy Tors, a country house set in the Centre's attractive grounds.



There are some magnificent views from the grounds of Westward Ho! Holiday Centre. The whole of Bideford Bay stretches out before you from Hartland Point to Baggy Point. Appledore can be seen and Lundy Isle, too. This view includes the beach at Westward Ho! It is ten minutes' walk down the picturesque "Zig Zag" path to the beach, but a coach service operates on weekdays (except Saturdays) at 9-30 a.m.

Guests are catered for at one sitting in the spacious dining room. The food—prepared in the modern kitchen with its up-to-the-minute equipment—is good, varied, and plentiful.

MENU

Wednesday 24th July 1963

8.30 a.m. Breakfast
Cornflakes
Bacon & Tomatoes
Tea. Bread: Butter & Marmalade

1.00 p.m. Lunch
Pea & Ham Soup
Lamb Chop. Mint Sauce
Peas
Boiled and Roast Potatoes
Apple and Blackcurrant Tart and Custard

6.00 p.m. Dinner
Minestrone Soup
Roast Pork. Apple Sauce
Spring Cabbage
Roast and Boiled Potatoes
Sliced Peaches and Ice Cream

Special Service for Babies





Every night there is something "going on" in the Raleigh Ballroom. The resident band plays for dancing three nights a week, and there are concerts, games, film shows, fancy dress parties for children—and Thursday night is Crazy Night!



In the comfortable Amyas Leigh Lounge, with its big open fireplace, you can watch your favourite TV programme. At the Centre's well stocked shop you may buy all those items you need on holiday and gifts to take home.





Across the lawns from the main building is the attractive Grenville Lounge with its two nautical bars well stocked with wines, spirits, and popular national beers. From the lounge windows is a fine view of Bideford Bay. Adjoining the Grenville is a Games Room. A serving hatch makes bar service available to those using this room.



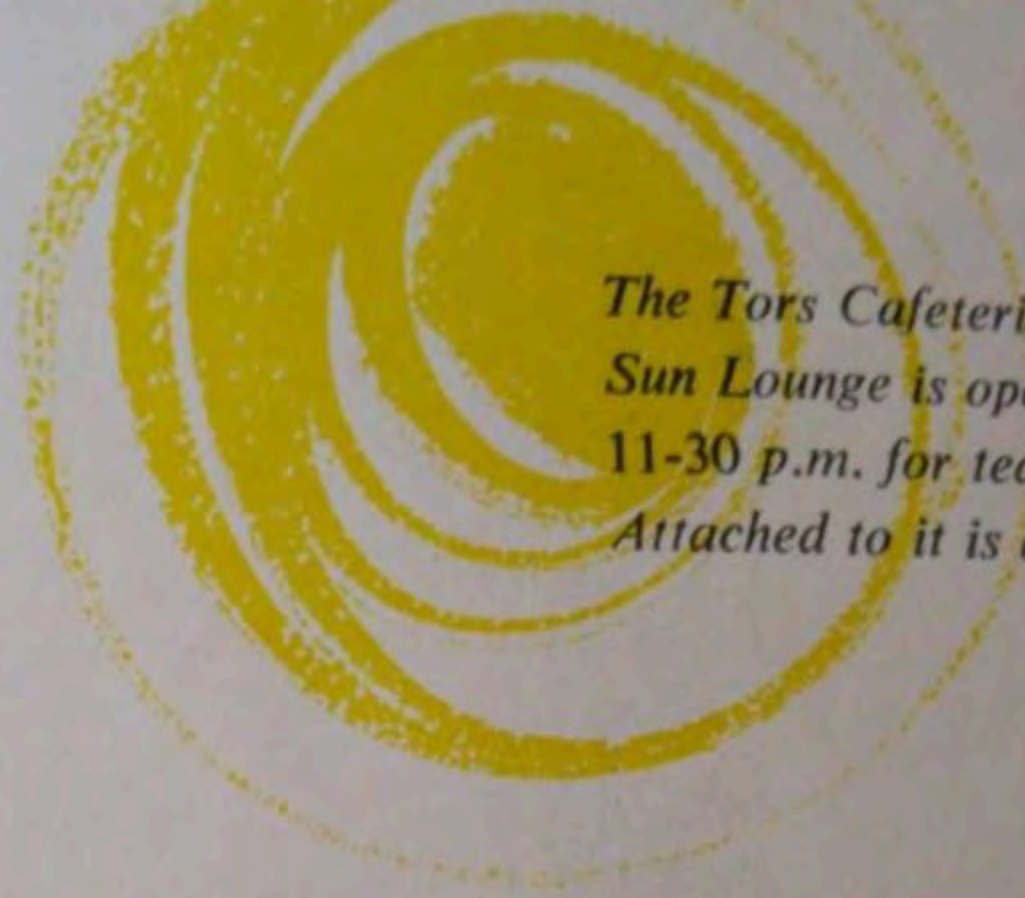

The Tors Cafeteria with its delightful Sun Lounge is open most of the day until 11-30 p.m. for tea, coffee, and snacks. Attached to it is a modern ice-cream bar.





In the billiard room there are three full-size tables. As with other sports and entertainments at the Centre, billiards and snooker are free. A deposit only (which is returnable) is required on the equipment.





The new Games Room, near the entrance to the Centre, is very popular with the younger, more energetic guests. Beetle Drives are less strenuous but they're great fun! Here's one in progress in the Sun Lounge alongside the Ballroom.





If tennis is your game, don't forget to pack your racket—Westward Ho! has four fine hard courts. As with other sports, there are tournaments, and prizes to be won!



All the family can have fun on the Centre's own Putting Green or the Pitch and Putt Course. For golfers, the famous Royal North Devon club is close at hand, and available at moderate fees.



FUN for the children



With an open-air playground including swings and roundabouts, a sandpit and a play hall, there is everything to keep the youngsters happy all the time.





An exciting new addition to the Centre is the Scandinavian Lounge where guests can relax in comfortable modern surroundings. For the more energetic the entertainment officers organise walks, outdoor sports, and games in the ballroom.



The spacious Scandinavian Lounge commands inspiring views of the sea—you'll love to linger in these restful surroundings, reading, meeting new friends, or just lazily relaxing.



Tournaments and competitions for adults and youngsters in all kinds of games and sports provide lots of excitement and fun.



The talented staff at the Centre put on a stage show for the guests. The guests are invited to put on a concert, too (under the direction of the entertainment officers). If you can do a turn on the stage, here's your big chance!





A WONDERFUL CENTRE FOR EXCURSIONS

Westward Ho! is in a region rich in beauty and of great historical interest. Half day and full day excursions may be made to famous beauty spots. Within a few miles of the Centre are such attractive places as Bideford, Clovelly, Bucks Mills, Boscastle, and Tintagel. A little further away is the notable Doone Valley and picturesque sister resorts Lynton and Lynmouth. Remember, if you are going on an excursion, packed lunches are available. For horse riding enthusiasts we can arrange for mounts from local stables.



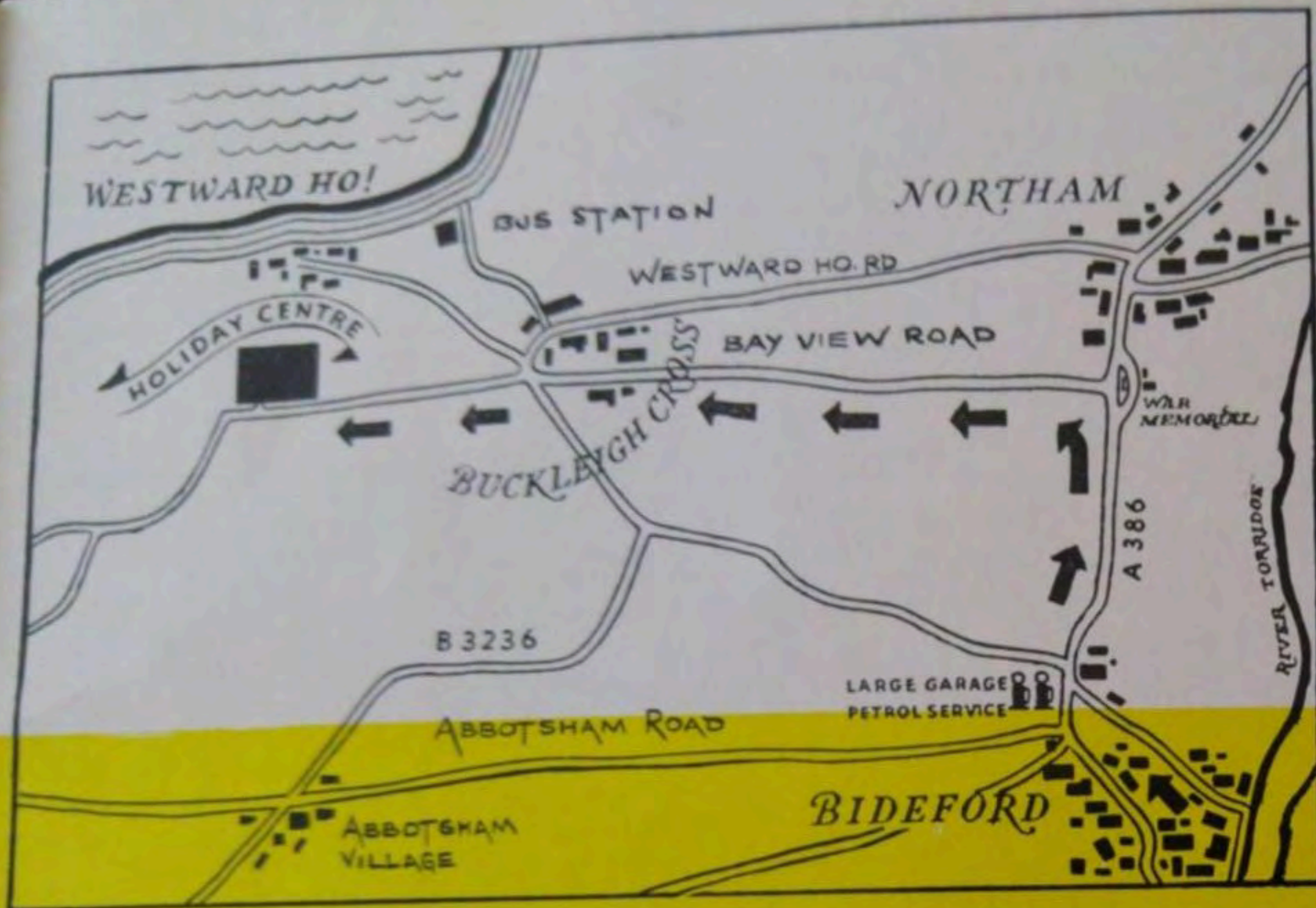

TRAVELLING TO THE 'CENTRE'

RAIL.—Nearest railway station is Bideford. Trains direct from Waterloo, London, with connections from the Midlands and North at Taunton or Exeter. During the season there are specially reserved compartments on one of the trains from Waterloo (Saturdays) at no extra charge. A bus service connects with all main trains and takes guests direct to the Centre.

COACHES.—Principal operators run services from main towns to Bideford. Royal Blue and Midland Red run a service direct to the Centre. Please enquire at your local Bus Office.

CAR.—On reaching Bideford, take the Northam Road, A386, turn left at the War Memorial (as indicated on the above map) and in three minutes you will come to the Centre.

A FEW MORE FACTS . . .

EARLY MORNING TEA

The Cafeteria is open on weekdays from 7 a.m. to 8 a.m. and Sundays 7-30 a.m. to 8-30 a.m. for those who enjoy an early morning cup of tea.

AIRING AND DRYING ROOM

For the convenience of guests there is an airing and drying room. Electric irons can be hired at a nominal fee and laundering is undertaken at a small charge.

A TRAINED NURSE is on duty at the Centre's First Aid Post.

A CHALET PATROL during the evening allows parents to enjoy themselves while their children sleep.

GARAGE.—There is covered accommodation and lock-ups for more than 90 cars at modest charges.

PETS.—You will appreciate that we are unable to admit dogs or other pets to the Centre, but there are local kennels available.



DEVON

Part of Somerset

Part of Cornwall

DEVON

Third largest county of England famous for its cream and cider its varied natural scenery and lovely Resorts

TRAVEL BY TRAIN

BRITISH RAILWAYS

BY COURTESY OF BRITISH RAILWAYS

Westward Ho! HOLIDAY CENTRE

Nr. BIDEFORD, NORTH DEVON. Telephone: MANAGER, Northam 495; GUESTS, Northam 497

Proprietors: TRAVCO HOTELS LTD., 65-69, Prescott Street, London, E.1.

Directors: R. Byrom, L. Cooke, O.B.E., J.P., A. E. F. Lovick, J.P., K. A. Noble, Lord Peddie, W. Quincey, J.P., W. T. Welch, J.P., A. Wild, J.P.

E.10—392821 (R10G)—S

Bonnyer